

Ferrite Sinter Magnet

Magnetic and physical properties

材質 GRADE	残留磁束密度 【Br】 Residual Flux Density	保磁力		最大エネルギー積 【(BH)max】 Max Energy Pduct	密度 Density
		【Hcb】 Coercive Force	【Hcj】 Intrinsic Coercive Force		
	mT (G)	kA/m (Oe)	kA/m (Oe)	kJ/m ³ (MGOe)	g/cm ³
DM10T(Y10T)	210-230 (2100-2300)	127-159 (1600-2000)	211-235 (2650-2950)	5.6-8.8 (0.7-1.1)	4.5-4.8
DM25 (Y25)	380-400 (3800-4000)	143-175 (1800-2200)	147-179 (1850-2250)	23.9-27.1 (3.0-3.4)	4.5-4.8
DM30 (Y30)	390-410 (3800-4200)	175-207 (2200-2600)	179-211 (2250-2650)	25.5-28.7 (3.2-3.6)	4.5-4.8
Y35	400-440 (4000-4400)	176-224 (2200-2800)	243-275 (3050-3450)	30.3-33.4 (3.8-4.2)	4.5-4.8
DM33H	390-410 (3900-4100)	239-271 (3000-3400)	243-275 (3050-3450)	27.1-30.3 (3.4-3.8)	4.8-5.0
DM34H	370-390 (3700-3900)	263-291 (3300-3650)	307-330 (3850-4150)	28.7-30.3 (3.6-3.8)	4.8-5.0
DM3845	370-390 (3700-3900)	263-299 (3300-3750)	342-378 (4300-4750)	25.5-28.7 (3.2-3.6)	4.8-5.0
DM3850	370-390 (3700-3900)	279-303 (3500-3800)	382-406 (4800-5100)	25.5-28.7 (3.2-3.6)	4.8-5.0
DM4036	395-415 (3950-4150)	263-291 (3300-3650)	279-303 (3500-3800)	28.7-31.8 (3.6-4.0)	4.8-5.0
DM4040	390-410 (3900-4100)	271-295 (3400-3700)	307-326 (3850-4100)	29.6-32.8 (3.7-4.1)	4.8-5.0
DM4129	400-420 (4000-4200)	215-239 (2700-3000)	219-243 (2750-3050)	29.6-32.8 (3.7-4.1)	4.8-5.0
DM4229	415-435 (4150-4350)	215-239 (2700-3000)	219-243 (2750-3050)	31.2-34.4 (3.9-4.3)	4.8-5.0
DM4240	410-430 (4100-4300)	283-307 (3550-3850)	307-330 (3850-4150)	31.8-35.2 (4.0-4.4)	4.8-5.0
DM4433	430-450 (4300-4500)	247-271 (3100-3400)	251-275 (3150-3450)	35.2-38.4 (4.4-4.8)	4.8-5.0
DM4045	390-410 (3900-4100)	287-310 (3600-3900)	347-370 (4350-4650)	28.7-31.8 (3.6-4.0)	4.8-5.0
DM4350	420-440 (4200-4400)	294-326 (3700-4100)	386-410 (4850-5150)	33.4-36.6 (4.2-4.6)	4.8-5.0
DM4545	440-460 (4400-4600)	318-350 (4000-4400)	347-370 (4350-4650)	36.6-39.8 (4.6-5.0)	4.8-5.0

Suggestive:

Besides the above grades, our company also have the process capacity to manufacture custom-made Ferrite Sinter magnet with specific characteristics to meet customers' requirements.

General Dimensions and Shapes

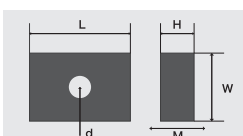

Block with Hole	
L	5.8-86mm
W	5.8-30mm
H	3.5-10mm
d	3.0-22mm

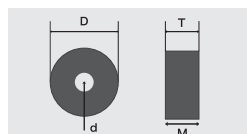

Disk	
D	8.0-274mm
d	4.8-114mm
T	2.5-38mm

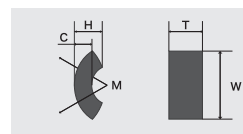

Segment	
W	20-100mm
T	15-115mm
H	10-36mm
C	4-15mm

Japan Magnets.,Inc

Head Office / Japan Bldg 4F, 1-1646-2, Kamikawa, Suwa, Nagano, Japan zipcode 392-0021

Tel / +81-266-56-1021

Fax / +81-266-56-1430

HP / <http://www.japanmagnets.net>